

INTERMODELLBAU 2011

13.-17. April 2011 – Halle 4

FAHRTTREPPE
Halle 4/3B

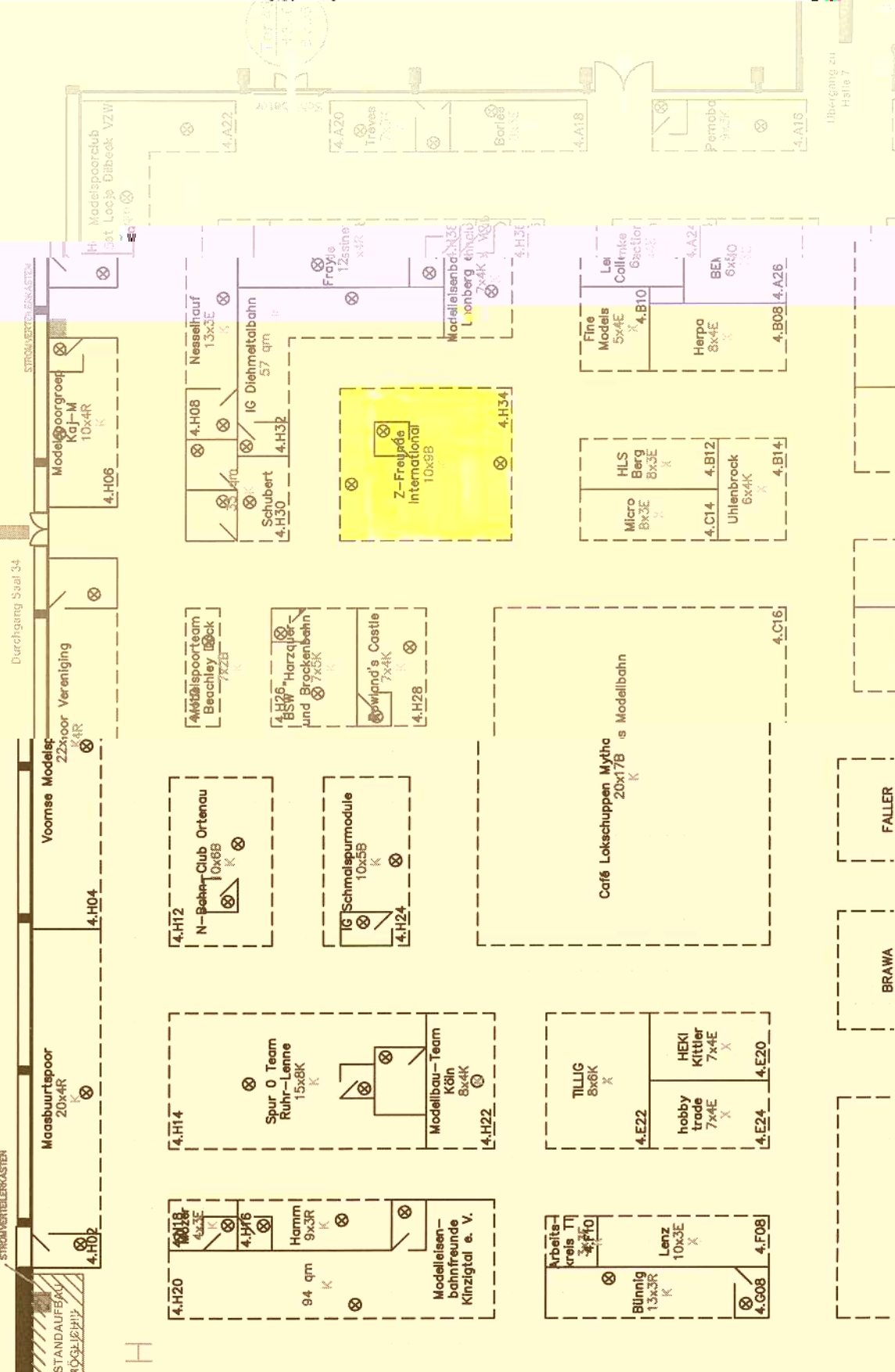
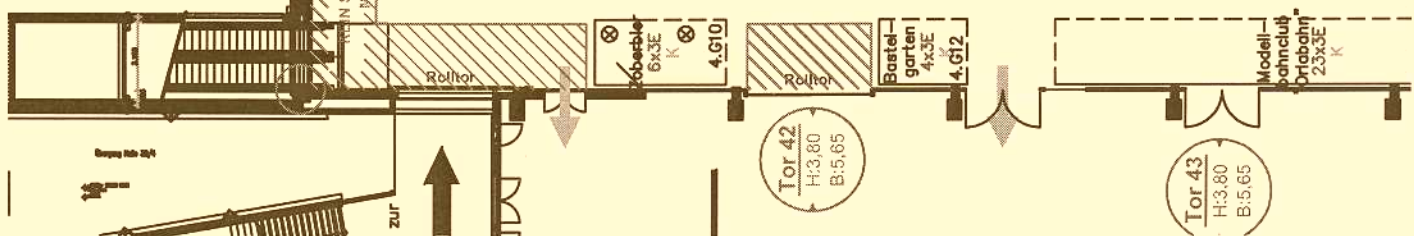

STROMVERTEILERKASTEN

Durchgang Saal 34

STROMVERTEILERKASTEN

Modellbauvereinigung

Voornse Modelist

Macsbuurtspoor

4.H06

4.H08

4.H10

4.H12

4.H14

4.H16

4.H18

4.H20

4.H22

4.H24

4.H26

4.H28

4.H30

4.H32

4.H34

4.H36

4.H38

4.H40

4.H42

4.H44

4.H46

4.H48

4.H50

4.H52

4.H54

4.H56

4.H58

4.H60

4.H62

4.H64

4.H66

4.H68

4.H70

4.H02

4.H04

4.H06

4.H08

4.H10

4.H12

4.H14

4.H16

4.H18

4.H20

4.H22

4.H24

4.H26

4.H28

4.H30

4.H32

4.H34

4.H36

4.H38

4.H40

4.H42

4.H44

4.H46

4.H48

4.H50

4.H52

4.H54

4.H56

4.H58

4.H60

4.H62

4.H64

4.H66

4.H68

4.H70

4.H72

4.H74

4.H76

4.H78

4.H80

4.H82

4.H84

4.H86

4.H88

4.H90

4.H02

4.H04

4.H06

4.H08

4.H10

4.H12

4.H14

4.H16

4.H18

4.H20

4.H22

4.H24

4.H26

4.H28

4.H30

4.H32

4.H34

4.H36

4.H38

4.H40

4.H42

4.H44

4.H46

4.H48

4.H50

4.H52

4.H54

4.H56

4.H58

4.H60

4.H62

4.H64

4.H66

4.H68

4.H70

4.H72

4.H74

4.H76

4.H78

4.H80

4.H82

4.H84

4.H86

4.H88

4.H90

4.H02

4.H04

4.H06

4.H08

4.H10

4.H12

4.H14

4.H16

4.H18

4.H20

4.H22

4.H24

4.H26

4.H28

4.H30

4.H32

4.H34

4.H36

4.H38

4.H40

4.H42

4.H44

4.H46

4.H48

4.H50

4.H52

4.H54

4.H56

4.H58

4.H60

4.H62

4.H64

4.H66

4.H68

4.H70

4.H72

4.H74

4.H76

4.H78

4.H80

4.H82

4.H84

4.H86

4.H88

4.H90

4.H02

4.H04

4.H06

4.H08

4.H10

4.H12

4.H14

4.H16

4.H18

4.H20

4.H22

4.H24

4.H26

4.H28

4.H30

4.H32

4.H34

4.H36

4.H38

4.H40

4.H42

4.H44

4.H46

4.H48

4.H50

4.H52

4.H54

4.H56

4.H58

4.H60

4.H62

4.H64

4.H66

4.H68

4.H70

4.H72

4.H74

4.H76

4.H78

4.H80

4.H82

4.H84

4.H86

4.H88

4.H90

4.H02

4.H04

4.H06

4.H08

4.H10

4.H12

4.H14

4.H16

4.H18

4.H20

4.H22

4.H24

4.H26

4.H28

4.H30

4.H32

4.H34

4.H36

4.H38

4.H40

4.H42

4.H44

4.H46

4.H48

4.H50

4.H52

4.H54

4.H56

4.H58

4.H60

4.H62

4.H64

4.H66

4.H68

4.H70

4.H72

4.H74

4.H76

4.H78

4.H80

4.H82

4.H84

4.H86

4.H88

4.H90

4.H02

4.H04

4.H06

4.H08

4.H10

4.H12

4.H14

4.H16

4.H18

4.H20

4.H22

4.H24

4.H26

4.H28

4.H30

4.H32

4.H34

4.H36

4.H38

4.H40

4.H42

4.H44

4.H46

4.H48

4.H50

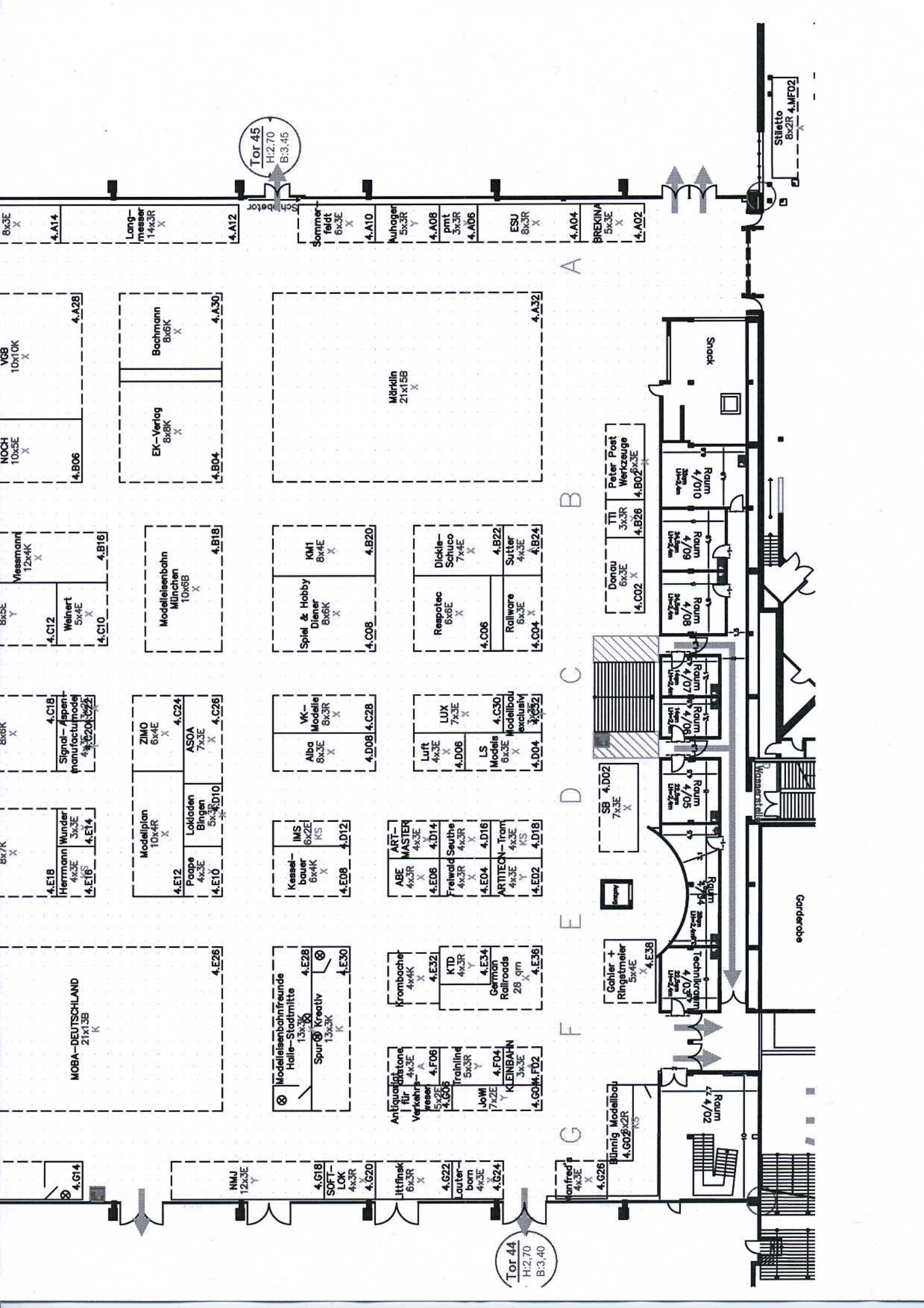

Tor 45
H:2,70
B:3,45

Tor 44
H:2,70
B:3,40

Stiletto
8x2R 4.MF02

8x3E X
4.A14
Lang-messer
14x3R X
4.A12

Sommerfeldt 6x3E X
4.A10
Auhagen 5x3R Y
4.A08
pmt 3x3R
4.A06
ESU 8x3R X
4.A04
BREKINA 5x3E X
4.A02

VGB 10x10K X
NOCH 10x5E X
4.B06
Eck-Verlag 8x8K X
4.B04
Bochmann 8x8K X
4.A30

Märklin 21x15B X
4.A32

Viesmann 12x4K X
4.C12
Weinert 5x4E X
4.C10

Modellbahn München 10x6B X
4.B18

Spiel & Hobby Diener 8x8K X
4.C08
KM1 8x4E X
4.B20

Respotec 6x6E X
4.C06
Dickle-Schuco 7x4E X
4.B22
Raliware 6x3E X
4.C04
Sutter 4x3E X
4.B24

Donau 6x3E X
4.C02
Peter Post Werkzeuge 4.B02 6x3E X
TTI 3x3R
4.B26

Snack
Raum 4/010
Raum 4/009
Raum 4/008
Raum 4/008
Raum 4/007
Raum 4/006
Raum 4/005

8x7K X
4.E18
Herrmann Wunder 4x3E 3x3E
4.E16 4.E14
Signal-Aspen manufacture model 4x3E 20x22
4.C18

Modellplan 10x4R X
4.E12
Präpe 4x3E
4.E10
Lokladen Bingen 7x3E
5x3E D10
ASOA 4.C28
ZIMO 6x4E X
4.C24

Kesselbauer 6x4K X
4.E08
IMS 6x2E KS
4.D12
Alba 8x3E X
4.D08
VK-Modelle 8x3R X
4.C28
LUX 7x3E X
4.D06
LS Models 6x3E X
4.D04
4.D02

ART-MASTER 4x3R X
4.E06
Freiwald Seuthe 4x3R X
4.E04
ARTITEON-Tram 4x3E X
4.E02
4.D18

SB 7x3E X
4.D02

Kleinstschiff
Garderobe

MOBA-DEUTSCHLAND 21x13B K
4.E28
Modellbahnfreunde Halle-Stadtmitt 13x3K X
4.E28
Spur 13x3K K
4.E30

Krombacher 4x4K X
4.E32
KTD 4x3R Y
4.E34
German Railroads 28 qm X
4.E36

Antiquarische Vertriebs 4x3E X
4.F06
Irrahline 5x3R Y
4.G06
JoWi 7x2E 4.F04
Y KLEINBAHN 3x3E X
4.G04 MF02

Gähler + Ringstemer 5x4E X
4.E38

Technikraum 4.C03 4.C03 4.C03
4.C03 4.C03 4.C03

4.G14

NMJ 12x3E Y
4.G18
SOFT-LOK 4x3R
4.G20

Jitfinsk 6x3R X
4.G22
Lauterborn 4x3E X
4.G24

Sanfred 4x3E X
4.G26
Bünnig Modellbau 4.G02 2x2R X

Raum 4/4/02

A

B

C

D

E

F

G